



The Vertex Companies, LLC

Insured: Jennifer [REDACTED] & Steven [REDACTED]
Property: [REDACTED]
Parker, CO 80134

Claim Rep.: Justin [REDACTED]
Company: Travelers Indemnity Company
Business: PO Box 650293
Dallas, TX 75265-0293

E-mail: [REDACTED]@travelers.com

Estimator: Kenneth [REDACTED]
Business: [REDACTED]
Irving, TX 75038

Cellular: (210) [REDACTED]
E-mail: [REDACTED]@vertexeng.com

Claim Number: ION [REDACTED]

Policy Number:

Type of Loss: Hail

Date of Loss: 6/6/2023 12:00 AM
Date Inspected: 7/24/2025 3:00 PM

Date Received:
Date Entered: 8/14/2025 8:48 AM

Price List: CODE8X_SEP23
Restoration/Service/Remodel
Estimate: VERTEX_106315

VERTEX_ [REDACTED]

Personal Property

DESCRIPTION	QUANTITY	UNIT PRICE	TAX	O&P	RCV	DEPREC.	ACV
1. Fireplace - Outdoor (Agreed Price)*	1.00 EA	128.66	0.00	25.74	154.40	(0.00)	154.40
*** https://www.homedepot.com/p/Outsunny-32-in-W-x-18-in-H-Square-Steel-Outdoor-Patio-Wood-Burning-Fire-Pit-Table-in-Black-with-Poker-and-Water-Resistant-Cover-842-073/313812426 ***							
2. Haul debris - per pickup truck load - including dump fees	0.50 EA	194.95	0.00	19.50	116.98	(0.00)	116.98
Totals: Personal Property			0.00	45.24	271.38	0.00	271.38

Roof

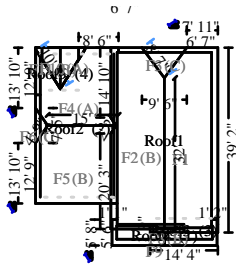

Roof1

1793.43 Surface Area
 260.36 Total Perimeter Length
 26.73 Total Hip Length
 17.93 Number of Squares
 55.92 Total Ridge Length

DESCRIPTION	QUANTITY	UNIT PRICE	TAX	O&P	RCV	DEPREC.	ACV
3. Tear off, haul and dispose of comp. shingles - Laminated	17.93 SQ	78.75	0.00	282.40	1,694.39	(0.00)	1,694.39
4. Remove Additional charge for high roof (2 stories or greater)	10.32 SQ	7.20	0.00	14.86	89.16	(0.00)	89.16
5. Remove Additional charge for steep roof - 7/12 to 9/12 slope	10.32 SQ	19.06	0.00	39.34	236.04	(0.00)	236.04
6. Add. layer of felt/underlayment, remove & disp.	17.93 SQ	9.88	0.00	35.44	212.59	(0.00)	212.59
7. Roofing felt - 30 lb.	27.71 SQ	61.16	39.02	346.74	2,080.50	(0.00)	2,080.50
Double coverage less the 816 SF of ice and water at the eaves							
8. Ice & water barrier	816.00 SF	2.45	32.64	406.36	2,438.20	(0.00)	2,438.20
Code require upgrade							
9. R&R Valley metal	25.10 LF	9.44	5.08	48.42	290.44	(0.00)	290.44
10. Asphalt starter - universal starter course	260.36 LF	3.10	14.58	164.34	986.04	(0.00)	986.04
11. Laminated - comp. shingle rfg. - w/out felt	20.33 SQ	366.05	257.90	1,539.94	9,239.64	(0.00)	9,239.64
Waste calculated at 12% due to roof configuration							
12. Additional charge for high roof (2 stories or greater)	11.56 SQ	33.89	0.00	78.36	470.13	(0.00)	470.13
Added for waste per email recommendation from Verisk provided by OA							
13. Additional charge for steep roof - 7/12 to 9/12 slope	11.56 SQ	76.74	0.00	177.42	1,064.53	(0.00)	1,064.53

CONTINUED - Roof1

DESCRIPTION	QUANTITY	UNIT PRICE	TAX	O&P	RCV	DEPREC.	ACV
Added for waste per email recommendation from Verisk provided by OA							
14. Hip / Ridge cap - Standard profile - composition shingles	82.65 LF	8.11	20.30	138.12	828.71	(0.00)	828.71
15. R&R Drip edge	260.36 LF	4.35	24.16	231.36	1,388.08	(0.00)	1,388.08
Note, pre-existing drip edge not removed by roofing contractor. New drip edge was install over existing. Also noted, gutters were not detached and reset, the new drip edge was hand cut around gutter hangars							
16. Paint trim (Drip Edge) - one coat*	260.36 LF	1.03	2.29	54.10	324.56	(0.00)	324.56
New drip edge not painted by roofing contractor							
17. R&R Flashing - pipe jack	4.00 EA	79.80	4.92	64.82	388.94	(0.00)	388.94
18. Prime & paint roof jack	4.00 EA	36.87	2.48	30.00	179.96	(0.00)	179.96
19. R&R Roof vent - turtle type - Metal	5.00 EA	107.43	8.84	109.20	655.19	(0.00)	655.19
20. Roof vent - turtle type - Metal	9.00 EA	95.18	15.92	174.50	1,047.04	(0.00)	1,047.04
Code Required Upgrade							
21. R&R Rain cap - 4" to 5"	1.00 EA	64.36	2.16	13.32	79.84	(0.00)	79.84
22. R&R Exhaust cap - through roof - up to 4"	1.00 EA	138.92	3.12	28.42	170.46	(0.00)	170.46
23. Remove Flashing - pipe jack - 6"	1.00 EA	9.60	0.00	1.92	11.52	(0.00)	11.52
For detach of existing furnace vent							
24. Install Flashing - pipe jack - 6"	1.00 EA	54.81	0.00	10.96	65.77	(0.00)	65.77
For install of existing furnace vent							
25. Prime & paint roof vent	17.00 EA	36.87	10.54	127.46	764.79	(0.00)	764.79
Note, turtle vents not painted by roofing contractor							
26. Clean roof vent	1.00 EA	21.95	0.01	4.40	26.36	(0.00)	26.36
Allow for cleaning of reused vent only to removed any adhesive.							
27. R&R Flashing - kick-out diverter	5.00 EA	44.33	5.16	45.38	272.19	(0.00)	272.19
28. Flashing - kick-out diverter	5.00 EA	38.31	5.16	39.36	236.07	(0.00)	236.07
Code required upgrade							
29. Step flashing	30.00 LF	15.84	4.73	95.98	575.91	(0.00)	575.91
30. Roofer - per hour	5.00 HR	216.04	0.00	216.04	1,296.24	(0.00)	1,296.24
Labor allowance for articulation of head wall flashing above garage, detach and reset of safety loops, and for material staging							
31. Caulking - silicone	23.00 LF	4.44	0.53	20.52	123.17	(0.00)	123.17
For caulking along head wall above garage.							
Totals: Roof1			459.54	4,539.48	27,236.46	0.00	27,236.46
Total: Roof			459.54	4,539.48	27,236.46	0.00	27,236.46

Exterior Elevations

Front Elevation

DESCRIPTION	QUANTITY	UNIT PRICE	TAX	O&P	RCV	DEPREC.	ACV
32. R&R Gutter - aluminum - up to 5"*	40.00 LF	11.80	16.61	97.72	586.33	(258.16)	328.17
33. R&R Downspout - aluminum - up to 5"*	13.00 LF	11.80	5.40	31.76	190.56	(83.90)	106.66
34. Prime & paint gutter / downspout	53.00 LF	1.74	1.19	18.68	112.09	(87.18)	24.91
35. R&R Window screen, 10 - 16 SF	2.00 EA	61.15	8.08	26.08	156.46	(0.00)	156.46
Totals: Front Elevation			31.28	174.24	1,045.44	429.24	616.20

Right Elevation

DESCRIPTION	QUANTITY	UNIT PRICE	TAX	O&P	RCV	DEPREC.	ACV
36. R&R Downspout - aluminum - up to 5"*	12.00 LF	11.80	4.98	29.32	175.90	(77.45)	98.45
37. Prime & paint gutter / downspout	12.00 LF	1.74	0.27	4.24	25.39	(19.74)	5.65
Totals: Right Elevation			5.25	33.56	201.29	97.19	104.10

Rear Elevation

DESCRIPTION	QUANTITY	UNIT PRICE	TAX	O&P	RCV	DEPREC.	ACV
38. Content Manipulation charge - per hour	1.00 HR	57.96	0.00	11.60	69.56	(0.00)	69.56
39. R&R Window screen, 10 - 16 SF	2.00 EA	61.15	8.08	26.08	156.46	(0.00)	156.46
40. Reglaze double-pane thermal window unit, 10 - 16 sf	3.00 EA	276.64	43.87	174.76	1,048.55	(0.00)	1,048.55
41. Add on for "Low E" glass	30.00 SF	3.96	9.50	25.66	153.96	(0.00)	153.96
42. R&R Downspout - aluminum - up to 5"*	40.00 LF	11.80	16.61	97.72	586.33	(258.16)	328.17
43. Prime & paint gutter / downspout	40.00 LF	1.74	0.90	14.10	84.60	(65.80)	18.80
44. R&R 5-0 6-8 vinyl sliding patio door	1.00 EA	997.00	55.01	210.40	1,262.41	(0.00)	1,262.41
45. R&R Additional charge for a retrofit sliding door	1.00 EA	444.24	5.47	89.94	539.65	(0.00)	539.65
46. Flashing - Sill flashing - moldable tape	25.00 LF	8.68	5.48	44.50	266.98	(0.00)	266.98
47. Window blind - horizontal or vertical - Detach & reset	1.00 EA	44.78	0.00	8.96	53.74	(0.00)	53.74
48. R&R Siding trim - 1" x 4" hardboard trim board	24.00 LF	9.47	3.07	46.06	276.41	(0.00)	276.41
49. Seal (1 coat) & paint (1 coat) trim	24.00 LF	1.52	0.27	7.36	44.11	(0.00)	44.11
50. Clean siding - wood	425.00 SF	0.57	0.34	48.52	291.11	(0.00)	291.11
51. Seal & paint wood siding	425.00 SF	2.69	17.68	232.20	1,393.13	(1,083.53)	309.60

CONTINUED - Rear Elevation

DESCRIPTION	QUANTITY	UNIT PRICE	TAX	O&P	RCV	DEPREC.	ACV
52. Mask and prep for paint - paper and tape (per LF)	140.00 LF	0.86	0.67	24.22	145.29	(0.00)	145.29
53. Mask or cover per square foot	110.00 SF	0.56	0.79	12.48	74.87	(0.00)	74.87
To cover doors and windows on rear elevation. Measurements taken from Hover Report							
Totals: Rear Elevation			167.74	1,074.56	6,447.16	1,407.49	5,039.67

Left Elevation

DESCRIPTION	QUANTITY	UNIT PRICE	TAX	O&P	RCV	DEPREC.	ACV
No damage observed or reported							
Totals: Left Elevation			0.00	0.00	0.00	0.00	0.00

Fencing

DESCRIPTION	QUANTITY	UNIT PRICE	TAX	O&P	RCV	DEPREC.	ACV
54. Clean with pressure/chemical spray	760.00 SF	0.50	0.61	76.12	456.73	(0.00)	456.73
55. Stain - wood fence/gate	760.00 SF	0.94	17.63	146.40	878.43	(390.41)	488.02
56. Wood fence plant holders & decor - Detach & reset*	10.00 EA	8.81	0.02	17.62	105.74	(0.00)	105.74
Totals: Fencing			18.26	240.14	1,440.90	390.41	1,050.49
Total: Exterior Elevations			222.53	1,522.50	9,134.79	2,324.33	6,810.46

General Conditions

DESCRIPTION	QUANTITY	UNIT PRICE	TAX	O&P	RCV	DEPREC.	ACV
57. Permits & Fees (Paid Bill)	1.00 EA	565.03	0.00	113.00	678.03	(0.00)	678.03
58. Temporary toilet - Minimum rental charge	1.00 EA	180.00	0.00	36.00	216.00	(0.00)	216.00
59. Tandem axle dump trailer - per load - including dump fees	1.00 EA	298.66	0.00	59.74	358.40	(0.00)	358.40
60. Residential Supervision / Project Management - per hour	8.00 HR	79.79	0.00	127.66	765.98	(0.00)	765.98



CONTINUED - General Conditions

DESCRIPTION	QUANTITY	UNIT PRICE	TAX	O&P	RCV	DEPREC.	ACV
Totals: General Conditions			0.00	336.40	2,018.41	0.00	2,018.41

Labor Minimums Applied

DESCRIPTION	QUANTITY	UNIT PRICE	TAX	O&P	RCV	DEPREC.	ACV
61. Siding labor minimum	1.00 EA	143.93	0.00	28.78	172.71	(0.00)	172.71
62. Window treatment repair	1.00 EA	143.18	0.00	28.64	171.82	(0.00)	171.82
63. General labor - labor minimum	1.00 EA	29.07	0.00	5.82	34.89	(0.00)	34.89
64. Fencing labor minimum	1.00 EA	328.66	0.00	65.74	394.40	(0.00)	394.40
Totals: Labor Minimums Applied			0.00	128.98	773.82	0.00	773.82
Line Item Totals: VERTEX_106315			682.07	6,572.60	39,434.86	2,324.33	37,110.53

Grand Total Areas:

0.00 SF Walls	0.00 SF Ceiling	0.00 SF Walls and Ceiling
0.00 SF Floor	0.00 SY Flooring	0.00 LF Floor Perimeter
0.00 SF Long Wall	0.00 SF Short Wall	0.00 LF Ceil. Perimeter
0.00 Floor Area	0.00 Total Area	0.00 Interior Wall Area
1,123.57 Exterior Wall Area	0.00 Exterior Perimeter of Walls	
1,793.43 Surface Area	17.93 Number of Squares	260.36 Total Perimeter Length
55.92 Total Ridge Length	26.73 Total Hip Length	

Coverage	Item Total	%	ACV Total	%
Dwelling	33,606.87	85.22%	31,672.95	85.35%
Other Structures	1,835.30	4.65%	1,444.89	3.89%
Contents	271.38	0.69%	271.38	0.73%
Code Upgrades	3,721.31	9.44%	3,721.31	10.03%
Total	39,434.86	100.00%	37,110.53	100.00%

Summary for Dwelling

Line Item Total	27,395.52
Material Sales Tax	610.09
Subtotal	28,005.61
Overhead	2,800.63
Profit	2,800.63
Replacement Cost Value	\$33,606.87
Less Depreciation	(1,933.92)
Actual Cash Value	\$31,672.95
Net Claim	\$31,672.95
Total Recoverable Depreciation	1,933.92
Net Claim if Depreciation is Recovered	\$33,606.87

Kenneth [REDACTED]

Summary for Other Structures

Line Item Total	1,511.16
Material Sales Tax	18.26
Subtotal	1,529.42
Overhead	152.94
Profit	152.94
Replacement Cost Value	\$1,835.30
Less Depreciation	(390.41)
Actual Cash Value	\$1,444.89
Net Claim	\$1,444.89
Total Recoverable Depreciation	390.41
Net Claim if Depreciation is Recovered	\$1,835.30

Kenneth [REDACTED]

Summary for Contents

Line Item Total	226.14
Overhead	22.62
Profit	22.62
Replacement Cost Value	\$271.38
Net Claim	\$271.38

Kenneth [REDACTED]



Summary for Code Upgrades

Line Item Total	3,047.37
Material Sales Tax	53.72
Subtotal	3,101.09
Overhead	310.11
Profit	310.11
Replacement Cost Value	\$3,721.31
Net Claim	\$3,721.31

Kenneth [REDACTED]

Recap by Category with Depreciation

O&P Items			RCV	Deprec.	ACV
CLEANING			644.20		644.20
Coverage: Dwelling	@	41.01% =	264.20		
Coverage: Other Structures	@	58.99% =	380.00		
CONTENT MANIPULATION			57.96		57.96
Coverage: Dwelling	@	100.00% =	57.96		
GENERAL DEMOLITION			3,055.45		3,055.45
Coverage: Dwelling	@	96.81% =	2,957.97		
Coverage: Contents	@	3.19% =	97.48		
PERMITS AND FEES			565.03		565.03
Coverage: Dwelling	@	100.00% =	565.03		
FENCING			416.76		416.76
Coverage: Other Structures	@	100.00% =	416.76		
FIREPLACES			128.66		128.66
Coverage: Contents	@	100.00% =	128.66		
GLASS, GLAZING, & STOREFRONTS			118.80		118.80
Coverage: Dwelling	@	100.00% =	118.80		
LABOR ONLY			667.39		667.39
Coverage: Dwelling	@	100.00% =	667.39		
MOISTURE PROTECTION			217.00		217.00
Coverage: Dwelling	@	100.00% =	217.00		
PAINTING			3,239.67	1,618.56	1,621.11
Coverage: Dwelling	@	77.95% =	2,525.27		
Coverage: Other Structures	@	22.05% =	714.40		
ROOFING			18,915.14		18,915.14
Coverage: Dwelling	@	83.89% =	15,867.77		
Coverage: Code Upgrades	@	16.11% =	3,047.37		
SIDING			462.29		462.29
Coverage: Dwelling	@	100.00% =	462.29		
SOFFIT, FASCIA, & GUTTER			1,166.55	653.26	513.29
Coverage: Dwelling	@	100.00% =	1,166.55		
TEMPORARY REPAIRS			180.00		180.00
Coverage: Dwelling	@	100.00% =	180.00		
WINDOWS - SLIDING PATIO DOORS			1,103.41		1,103.41
Coverage: Dwelling	@	100.00% =	1,103.41		
WINDOW REGLAZING & REPAIR			1,053.92		1,053.92
Coverage: Dwelling	@	100.00% =	1,053.92		
WINDOW TREATMENT			187.96		187.96
Coverage: Dwelling	@	100.00% =	187.96		
O&P Items Subtotal			32,180.19	2,271.82	29,908.37
Material Sales Tax			682.07	52.51	629.56
Coverage: Dwelling	@	89.45% =	610.09		
Coverage: Other Structures	@	2.68% =	18.26		



Coverage: Code Upgrades	@	7.88% =	53.72		
Overhead			3,286.30		3,286.30
Coverage: Dwelling	@	85.22% =	2,800.63		
Coverage: Other Structures	@	4.65% =	152.94		
Coverage: Contents	@	0.69% =	22.62		
Coverage: Code Upgrades	@	9.44% =	310.11		
Profit			3,286.30		3,286.30
Coverage: Dwelling	@	85.22% =	2,800.63		
Coverage: Other Structures	@	4.65% =	152.94		
Coverage: Contents	@	0.69% =	22.62		
Coverage: Code Upgrades	@	9.44% =	310.11		
Total			39,434.86	2,324.33	37,110.53

